

HYDRAULIC OPENING SYSTEM – 619.111

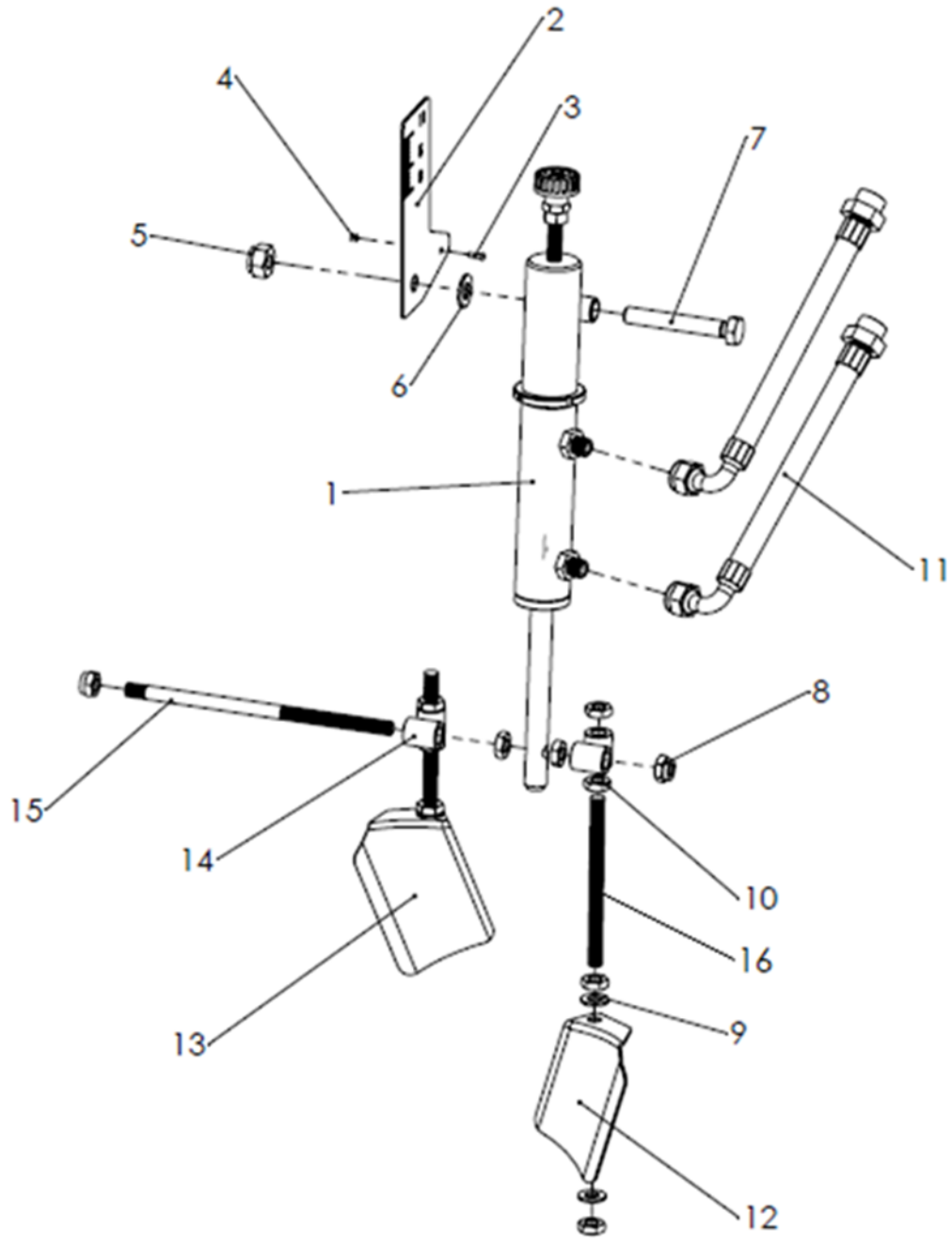

POS	QTY	CODE	DESCRIPTION
1	1	623.021	DOUBLE EFFECT HYDRAULIC CYLINDER
2	1	620.278	GRADUATED RULER
3	1	300.179	HEXAGON SOCKET BUTTON HEAD SCREW M3X10 ISO 7380SS
4	1	301.103	NYLON INSERT HIGH HEX LOCK NUT M3 ISO 7040 SS
5	1	301.087	NYLON INSERT HIGH HEX LOCK NUT M12 ISO 7040 SS
6	1	303.060	FLAT WASHER 12X24 ISO 7089 SS
7	1	300.119	FULL THREAD HEXAGON HEAD SCREW M2X80 ISO 4017 SS
8	2	301.068	NYLON INSERT THIN HEX LOCK NUTS M10 ISO 10511 SS
9	4	303.052	FLAT WASHER 10X20 ISO 7089 SS
10	10	301.066	THIN HEX NUT M10 ISO 4035 SS
11	2	304.060	HYDRAULIC HOSE
12	1	605.006	LEFT SHUTTER
13	1	605.005	RIGHT SHUTTER
14	2	325.080	TIE ROD BUSHING
15	1	602.040	TIE ROD OF ADJUSTING
16	2	602.052	VERTICAL TIE ROD